

# Brida CCT Hvid/Sort

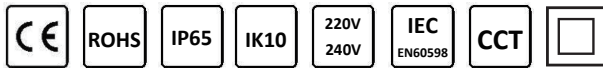

## Product informaton

Hvid/Sort UV resistance LED ceiling light, power can adjust between 10W / 11W / 13W / 14W / 15W / 16W / 18W, color temperature can adjust between 3000K-4000K

## Features

- \* UV resistance housing
- \* Anti-theft & retained screws
- \* Plastic plug to hide the screws
- \* Cable entrance for both bottom and side wiring
- \* Knock-out holes for side wiring
- \* LED efficiency 123lm/W at 4000K for Hvid fitting color, LED efficiency 117lm/W at 4000K for Sort fitting color
- \* Power Switchable
- \* Color Temperature Selectable
- \* Basic on/off function

## Product data

General Informadon	
Light source type	LED
Number of LED module	1 Pcs
Beam angle of LED module	120°
Color temperature	3000K, 3500K, 4000K
CRI	80
LED module replaceable	NO
Number of LED driver	1 Unit
Driver included	Yes
L90 life time of LED module	49,000 hrs
L80 life time of LED module	102,000 hrs
LED module lumen	Hvid: 3000K:2124lm 3500K:2178lm 4000K:2214lm Sort: 3000K:2016lm 3500K:2070lm 4000K:2106lm
Operaring and Electrical	
Input Voltage	220-240 Vac
Input frequency	50 to 60 Hz
System wattage	10/11/13/14/15/16/18W
Inrush current	18.2A
Inrush time	52µs
Power factor	≥0.9
Surge protection	1KV(L/N-Ground)
Ambient temperature range	-20°C to + 40°C
Performance ambient temperature Tq	+25°C
SDCM	<3 steps

Diffuser type	PC
Control and dimming	On/Off
Connection type	2 pole connector
Protection class IEC	Safety class II
Glow-wire test	Temperature 650°C
UGR	from 21
PstLM	<1
SVM	<0.4
CE Mark	Yes
EU RoHS compliant	Yes
Net weight (piece)	0.94Kg
Dimension	
Overall length	290mm
Overall width	290mm
Overall height	55mm
Mechanical and Housing	
Housing material	PC
Diffuser material	PC
Housing color	Hvid / Sort
Ingress protection code	IP65
Meeh, impact protection code	IK10
Remarks	
LED driver failure rate at 50,000hrs@25°C	5%
Power consumption tolerance	±5%

## Specifications

Varenummer	LED Module Wattage*	Length mm	Width mm	Height mm	CCT (Kelvin)*	Rated Flux (Lm) *	CRI (Ra)*	Beam angle*	Energy Class	Dimming technology
5702218290109 (Hvid)	18	290	290	55	3000K	2124	80	120°	D	NO
5702218290109 (Hvid)	18	290	290	55	3500K	2178	80	120°	D	NO
5702218290109 (Hvid)	18	290	290	55	4000K	2214	80	120°	D	NO
5702218290208 (Sort)	18	290	290	55	3000K	2016	80	120°	D	NO
5702218290208 (Sort)	18	290	290	55	3500K	2070	80	120°	D	NO
5702218290208 (Sort)	18	290	290	55	4000K	2106	80	120°	D	NO

\* Due to the special conditons of the manufacturing processes of LED, the typical data of technical parameters can only reflect statistical figures and do not necessarily correspond to the actual parameters of each single product which could differ from the typical value. A max 10% tolerance is deemed to be acceptable in any case.

## Circuit Breaker

Circuit breaker model No.	B10	B13	B16	B20	C10	C13	C16	C20
Product name								
Brida CCT Hvid / Sort	79	103	125	158	79	103	125	158

## Dimension drawings

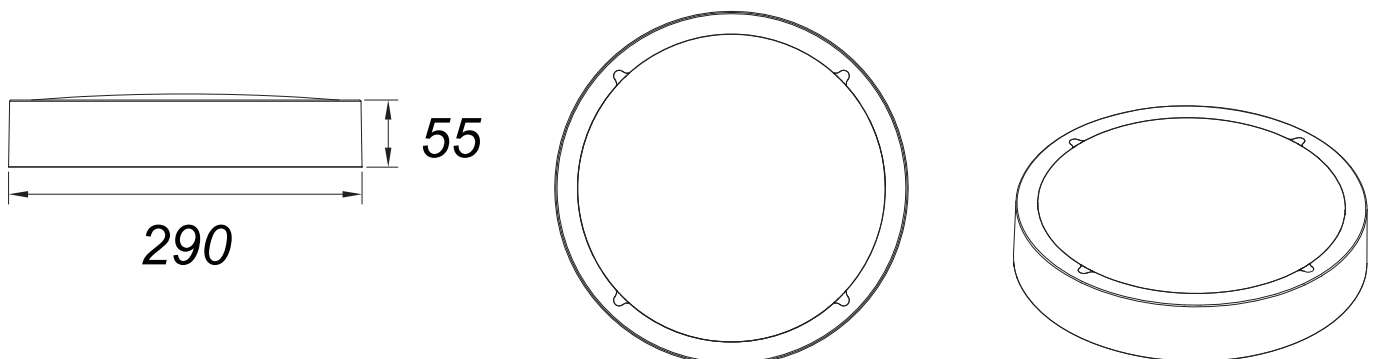

# Installation manual

**1**

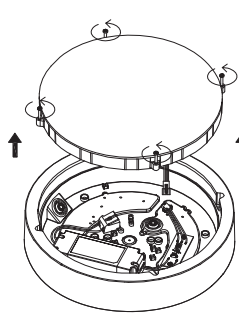

Unscrew the diffuser anticlockwise.  
Vertically remove the diffuser and PCBA.

**2**

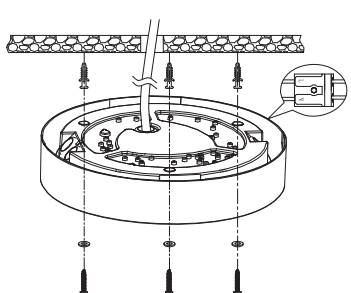

a. Cut off the power. Thread the input cable through the rubber plug to the fixture. Connect the L, N wire referring to the wiring diagram.  
b. Knock the rawl plugs into the pre-drilled holes on ceiling. Wear plastic washers on self-tapping screws and tighten them to fix the fixture on ceiling.

**3**

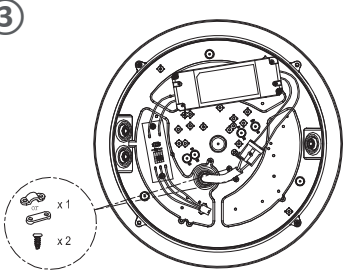

Install the cable clip.

**4**

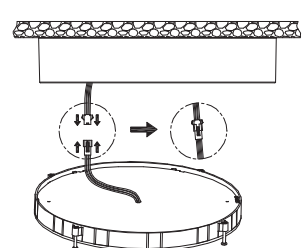

Connect the DC cable.

**5**

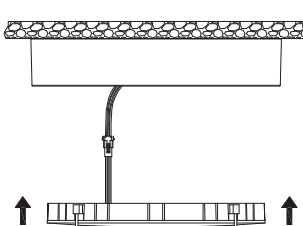

Mount the diffuser onto the base with screws.

**6**

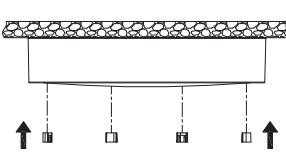

Install the plastic plugs to hide the screws.

1 Installation

**Wattage Setting**

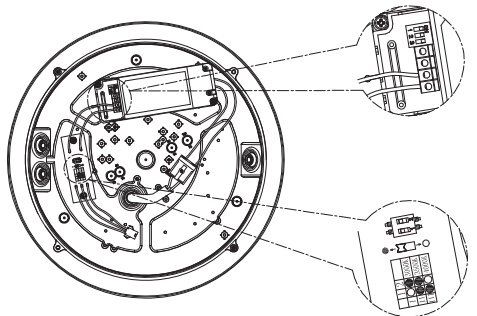

P <sub>in</sub>	I <sub>out</sub>	1	2	3
10W	400mA	—	—	—
11W	450mA	—	—	ON
13W	500mA	ON	—	—
14W	550mA	—	ON	—
15W	600mA	—	ON	ON
16W	650mA	ON	ON	—
18W	700mA	ON	ON	ON

**CCT Setting**

I	II	III
○	●	●
3000K	3500K	4000K

ON / OFF  
1 2 3

2 Wattage / CCT Setting

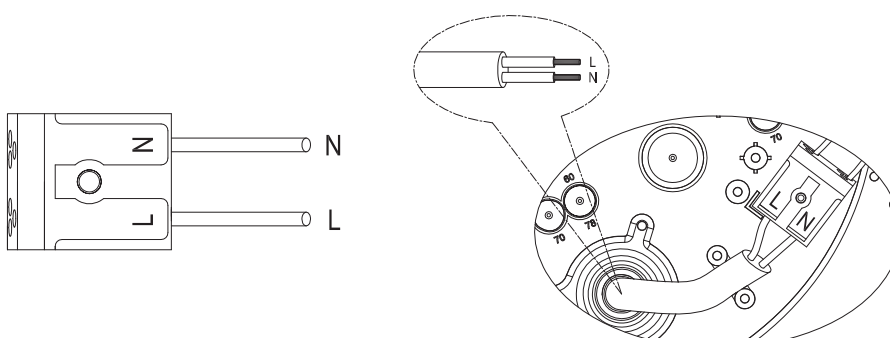

The min. diameter is  $\geq 0.75\text{mm}^2$   
Dimension:  $\phi 8.5\text{mm} < \text{Cable} < \phi 11\text{mm}$

3 Connecting Power Supply

#### 4 Explosion Drawing

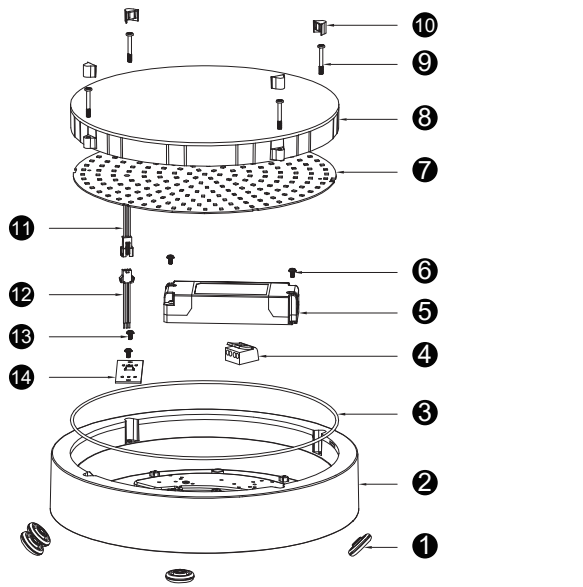

- |                            |                                |
|----------------------------|--------------------------------|
| ① Waterproof rubber plug   | ⑧ Diffuser                     |
| ② Base                     | ⑨ Vandal-proof screw           |
| ③ Waterproof ring          | ⑩ Plastic screw plug           |
| ④ Terminal block           | ⑪ DC cable male plug           |
| ⑤ Driver                   | ⑫ DC cable female plug         |
| ⑥ Screws for driver fixing | ⑬ Screws for CCT switch fixing |
| ⑦ LED Board                | ⑭ CCT switch                   |

#### 5 Accessory

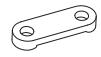

Cable Clip

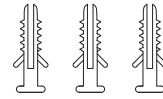

φ6x25mm Rawl plug



PB3x8mm Screws  
(fix cable clip)

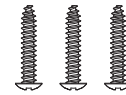

PA4x25mm Screws  
(fix the fixture)



Vandal-proof  
Screw Tool



φ8 Waterproof  
Silicone Washer

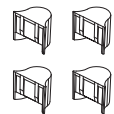

Plastic Plug



DK: Må kun installeres af autoriseret elinstallatør  
EN: Only to be installed by an authorized electrician.

**EVERFINE GONIOPHOTOMETERS SYSTEM TEST REPORT**

**UGR(Unified Glare Rating) Table**

Test:U:221.70V I:0.0850A P:17.800W PF:0.9390 Freq:50.00Hz		
Lamp Flux:2281.13x1 lm		
Name: Brida CCT Hvid	Type:	
MFR.:	DIM.: $\phi$ 290*55 (mm)	
	SUR.: $\phi$ 252 (mm)	

<b>ceiling/cavity</b>	<b>0.7</b>	<b>0.7</b>	<b>0.5</b>	<b>0.5</b>	<b>0.3</b>	<b>0.7</b>	<b>0.7</b>	<b>0.5</b>	<b>0.5</b>	<b>0.3</b>
<b>walls</b>	<b>0.5</b>	<b>0.3</b>	<b>0.5</b>	<b>0.3</b>	<b>0.3</b>	<b>0.5</b>	<b>0.3</b>	<b>0.5</b>	<b>0.3</b>	<b>0.3</b>
<b>working plane</b>	<b>0.2</b>	<b>0.2</b>	<b>0.2</b>	<b>0.2</b>	<b>0.2</b>	<b>0.2</b>	<b>0.2</b>	<b>0.2</b>	<b>0.2</b>	<b>0.2</b>
<b>Room dimensions</b>	<b>Viewed crosswise</b>					<b>Viewed endwise</b>				
<b>x = 2H y = 2H</b>	<b>21.2</b>	<b>22.8</b>	<b>21.6</b>	<b>23.1</b>	<b>23.5</b>	<b>21.2</b>	<b>22.8</b>	<b>21.6</b>	<b>23.1</b>	<b>23.5</b>
<b>3H</b>	<b>23.0</b>	<b>24.5</b>	<b>23.5</b>	<b>24.9</b>	<b>25.3</b>	<b>23.0</b>	<b>24.5</b>	<b>23.4</b>	<b>24.8</b>	<b>25.3</b>
<b>4H</b>	<b>23.7</b>	<b>25.1</b>	<b>24.2</b>	<b>25.5</b>	<b>25.9</b>	<b>23.7</b>	<b>25.1</b>	<b>24.2</b>	<b>25.5</b>	<b>25.9</b>
<b>6H</b>	<b>24.3</b>	<b>25.5</b>	<b>24.7</b>	<b>26.0</b>	<b>26.4</b>	<b>24.2</b>	<b>25.5</b>	<b>24.7</b>	<b>25.9</b>	<b>26.4</b>
<b>8H</b>	<b>24.5</b>	<b>25.7</b>	<b>24.9</b>	<b>26.1</b>	<b>26.6</b>	<b>24.4</b>	<b>25.6</b>	<b>24.9</b>	<b>26.1</b>	<b>26.5</b>
<b>12H</b>	<b>24.6</b>	<b>25.7</b>	<b>25.1</b>	<b>26.2</b>	<b>26.7</b>	<b>24.6</b>	<b>25.7</b>	<b>25.0</b>	<b>26.1</b>	<b>26.6</b>
<b>4H 2H</b>	<b>21.8</b>	<b>23.2</b>	<b>22.3</b>	<b>23.6</b>	<b>24.0</b>	<b>21.8</b>	<b>23.2</b>	<b>22.3</b>	<b>23.6</b>	<b>24.0</b>
<b>3H</b>	<b>23.9</b>	<b>25.0</b>	<b>24.3</b>	<b>25.5</b>	<b>25.9</b>	<b>23.9</b>	<b>25.0</b>	<b>24.3</b>	<b>25.5</b>	<b>25.9</b>
<b>4H</b>	<b>24.7</b>	<b>25.8</b>	<b>25.2</b>	<b>26.2</b>	<b>26.7</b>	<b>24.7</b>	<b>25.7</b>	<b>25.2</b>	<b>26.2</b>	<b>26.7</b>
<b>6H</b>	<b>25.4</b>	<b>26.3</b>	<b>25.9</b>	<b>26.8</b>	<b>27.3</b>	<b>25.4</b>	<b>26.3</b>	<b>25.9</b>	<b>26.8</b>	<b>27.3</b>
<b>8H</b>	<b>25.6</b>	<b>26.5</b>	<b>26.1</b>	<b>27.0</b>	<b>27.5</b>	<b>25.6</b>	<b>26.5</b>	<b>26.1</b>	<b>26.9</b>	<b>27.5</b>
<b>12H</b>	<b>25.8</b>	<b>26.6</b>	<b>26.3</b>	<b>27.1</b>	<b>27.6</b>	<b>25.8</b>	<b>26.5</b>	<b>26.3</b>	<b>27.1</b>	<b>27.6</b>
<b>8H 4H</b>	<b>25.1</b>	<b>25.9</b>	<b>25.6</b>	<b>26.4</b>	<b>26.9</b>	<b>25.0</b>	<b>25.9</b>	<b>25.5</b>	<b>26.4</b>	<b>26.9</b>
<b>6H</b>	<b>25.9</b>	<b>26.6</b>	<b>26.4</b>	<b>27.1</b>	<b>27.6</b>	<b>25.8</b>	<b>26.5</b>	<b>26.4</b>	<b>27.1</b>	<b>27.6</b>
<b>8H</b>	<b>26.2</b>	<b>26.8</b>	<b>26.7</b>	<b>27.4</b>	<b>27.9</b>	<b>26.1</b>	<b>26.8</b>	<b>26.7</b>	<b>27.3</b>	<b>27.9</b>
<b>12H</b>	<b>26.4</b>	<b>27.0</b>	<b>27.0</b>	<b>27.5</b>	<b>28.2</b>	<b>26.4</b>	<b>27.0</b>	<b>26.9</b>	<b>27.5</b>	<b>28.1</b>
<b>12H 4H</b>	<b>25.1</b>	<b>25.9</b>	<b>25.6</b>	<b>26.4</b>	<b>26.9</b>	<b>25.1</b>	<b>25.8</b>	<b>25.6</b>	<b>26.4</b>	<b>26.9</b>
<b>6H</b>	<b>25.9</b>	<b>26.6</b>	<b>26.5</b>	<b>27.1</b>	<b>27.7</b>	<b>25.9</b>	<b>26.5</b>	<b>26.5</b>	<b>27.1</b>	<b>27.6</b>
<b>8H</b>	<b>26.3</b>	<b>26.9</b>	<b>26.9</b>	<b>27.4</b>	<b>28.0</b>	<b>26.3</b>	<b>26.8</b>	<b>26.8</b>	<b>27.4</b>	<b>28.0</b>
<b>CIE190: 2010</b>										

**CIE190: 2010**  
**Area: 0.05 m2**

**C Range: 0 - 360DEG**  
**C Interval: 30.0DEG**  
**Test Speed: HIGH**  
**Temperature:25.3DEG**  
**Operators:DAMIN**  
**Test Date:2022-04-28**

**$\gamma$  Range: 0 - 180DEG**  
 **$\gamma$  Interval: 1.0DEG**  
**Test System:EVERFINE GO-2000A\_V1 SYSTEM V2.00.443**  
**Humidity:65.0%**  
**Test Distance:8.000m [K=0.7063]**  
**Remarks:**

**EVERFINE GONIOPHOTOMETERS SYSTEM TEST REPORT**

**UGR(Unified Glare Rating) Table**

Test:U:220.70V I:0.0850A P:17.600W PF:0.9400 Freq:50.00Hz										
Lamp Flux:2113.44x1 lm										
Name: Brida CCT Sort					Type:					
MFR.:					DIM.: $\phi$ 290*55 (mm)					
					SUR.: $\phi$ 252 (mm)					
<b>ceiling/cavity</b>	<b>0.7</b>	<b>0.7</b>	<b>0.5</b>	<b>0.5</b>	<b>0.3</b>	<b>0.7</b>	<b>0.7</b>	<b>0.5</b>	<b>0.5</b>	<b>0.3</b>
<b>walls</b>	<b>0.5</b>	<b>0.3</b>	<b>0.5</b>	<b>0.3</b>	<b>0.3</b>	<b>0.5</b>	<b>0.3</b>	<b>0.5</b>	<b>0.3</b>	<b>0.3</b>
<b>working plane</b>	<b>0.2</b>	<b>0.2</b>	<b>0.2</b>	<b>0.2</b>	<b>0.2</b>	<b>0.2</b>	<b>0.2</b>	<b>0.2</b>	<b>0.2</b>	<b>0.2</b>
<b>Room dimensions</b>	<b>Viewed crosswise</b>					<b>Viewed endwise</b>				
<b>x = 2H y = 2H</b>	<b>21.0</b>	<b>22.6</b>	<b>21.4</b>	<b>22.9</b>	<b>23.3</b>	<b>20.8</b>	<b>22.4</b>	<b>21.2</b>	<b>22.7</b>	<b>23.1</b>
<b>3H</b>	<b>22.8</b>	<b>24.2</b>	<b>23.2</b>	<b>24.6</b>	<b>25.0</b>	<b>22.5</b>	<b>23.9</b>	<b>22.9</b>	<b>24.3</b>	<b>24.7</b>
<b>4H</b>	<b>23.5</b>	<b>24.8</b>	<b>23.9</b>	<b>25.2</b>	<b>25.7</b>	<b>23.1</b>	<b>24.5</b>	<b>23.6</b>	<b>24.9</b>	<b>25.3</b>
<b>6H</b>	<b>24.0</b>	<b>25.2</b>	<b>24.4</b>	<b>25.6</b>	<b>26.1</b>	<b>23.6</b>	<b>24.8</b>	<b>24.0</b>	<b>25.2</b>	<b>25.7</b>
<b>8H</b>	<b>24.1</b>	<b>25.3</b>	<b>24.6</b>	<b>25.8</b>	<b>26.2</b>	<b>23.7</b>	<b>24.9</b>	<b>24.2</b>	<b>25.4</b>	<b>25.8</b>
<b>12H</b>	<b>24.2</b>	<b>25.4</b>	<b>24.7</b>	<b>25.8</b>	<b>26.3</b>	<b>23.9</b>	<b>25.0</b>	<b>24.3</b>	<b>25.4</b>	<b>25.9</b>
<b>4H 2H</b>	<b>21.6</b>	<b>22.9</b>	<b>22.0</b>	<b>23.3</b>	<b>23.8</b>	<b>21.4</b>	<b>22.8</b>	<b>21.9</b>	<b>23.2</b>	<b>23.6</b>
<b>3H</b>	<b>23.6</b>	<b>24.7</b>	<b>24.1</b>	<b>25.2</b>	<b>25.6</b>	<b>23.4</b>	<b>24.5</b>	<b>23.8</b>	<b>24.9</b>	<b>25.4</b>
<b>4H</b>	<b>24.4</b>	<b>25.4</b>	<b>24.9</b>	<b>25.9</b>	<b>26.4</b>	<b>24.1</b>	<b>25.1</b>	<b>24.6</b>	<b>25.6</b>	<b>26.1</b>
<b>6H</b>	<b>25.0</b>	<b>25.9</b>	<b>25.5</b>	<b>26.4</b>	<b>26.9</b>	<b>24.7</b>	<b>25.6</b>	<b>25.2</b>	<b>26.1</b>	<b>26.6</b>
<b>8H</b>	<b>25.3</b>	<b>26.1</b>	<b>25.8</b>	<b>26.6</b>	<b>27.1</b>	<b>24.9</b>	<b>25.7</b>	<b>25.4</b>	<b>26.2</b>	<b>26.7</b>
<b>12H</b>	<b>25.4</b>	<b>26.2</b>	<b>25.9</b>	<b>26.7</b>	<b>27.2</b>	<b>25.1</b>	<b>25.8</b>	<b>25.6</b>	<b>26.3</b>	<b>26.9</b>
<b>8H 4H</b>	<b>24.7</b>	<b>25.5</b>	<b>25.2</b>	<b>26.0</b>	<b>26.5</b>	<b>24.4</b>	<b>25.3</b>	<b>24.9</b>	<b>25.7</b>	<b>26.3</b>
<b>6H</b>	<b>25.4</b>	<b>26.1</b>	<b>26.0</b>	<b>26.7</b>	<b>27.2</b>	<b>25.1</b>	<b>25.8</b>	<b>25.7</b>	<b>26.4</b>	<b>26.9</b>
<b>8H</b>	<b>25.7</b>	<b>26.4</b>	<b>26.3</b>	<b>26.9</b>	<b>27.5</b>	<b>25.4</b>	<b>26.0</b>	<b>26.0</b>	<b>26.6</b>	<b>27.1</b>
<b>12H</b>	<b>26.0</b>	<b>26.5</b>	<b>26.5</b>	<b>27.1</b>	<b>27.7</b>	<b>25.7</b>	<b>26.2</b>	<b>26.2</b>	<b>26.7</b>	<b>27.4</b>
<b>12H 4H</b>	<b>24.7</b>	<b>25.5</b>	<b>25.2</b>	<b>26.0</b>	<b>26.5</b>	<b>24.5</b>	<b>25.2</b>	<b>25.0</b>	<b>25.7</b>	<b>26.3</b>
<b>6H</b>	<b>25.5</b>	<b>26.1</b>	<b>26.1</b>	<b>26.6</b>	<b>27.2</b>	<b>25.2</b>	<b>25.8</b>	<b>25.8</b>	<b>26.3</b>	<b>26.9</b>
<b>8H</b>	<b>25.8</b>	<b>26.4</b>	<b>26.4</b>	<b>26.9</b>	<b>27.5</b>	<b>25.5</b>	<b>26.1</b>	<b>26.1</b>	<b>26.6</b>	<b>27.2</b>
<b>CIE190: 2010</b>										

CIE190: 2010  
Area: 0.049 m2

**C Range: 0 - 360DEG**  
**C Interval: 30.0DEG**  
**Test Speed: HIGH**  
**Temperature:25.3DEG**  
**Operators:DAMIN**  
**Test Date:2022-05-26**

**$\gamma$  Range: 0 - 180DEG**  
 **$\gamma$  Interval: 1.0DEG**  
**Test System:EVERFINE GO-2000A\_V1 SYSTEM V2.00.443**  
**Humidity:65.0%**  
**Test Distance:8.000m [K=0.7063]**  
**Remarks:**